



We bring speech to life™

wego™ write

Predictable User Guide

For **wego™ write-D** Speech-Generating Devices



Find more resources online:

www.talktometechnologies.com/support/

Table of contents

Hardware and features.....	2
Guided Access.....	4
Quick Keys	5
Settings	5
Phrase categories.....	6
Phrases.....	8
Speech.....	11
Pronunciation	12
Abbreviations	13
Word prediction	14
Message history	15
Emotes.....	16
Floor hold	17
Install communication software updates.....	18
User information and notes	19

Hardware and features

Power

Press and hold this button to turn the device on or off. To conserve battery life when the **wego™ write** is not in use, press the power button once to place in “Sleep” mode.

Volume

Press volume toggle to the left to increase speaker volume or to the right to decrease volume.

Lock screen

You can turn on Lock Screen to lock the screen orientation. Switch button to left to unlock and to right to lock screen orientation.

Quick Keys

The **wego™ write** touchscreen and keyboard features several quick keys: delete, speak, phrases, and emotes. The touchscreen also features the Use button containing options on how to share your message.



● Charging the **wego™ write**

Charge device, speaker, and keyboard at night or when not in use. Please only use TTMT-approved charging cables to charge your device.

● Keyboard power

Press the keyboard power button once to turn off and on. To conserve battery life, turn off the keyboard when not using with the **wego™ write**.

● Detach the magnetic keyboard

To use the **wego™ write** without the keyboard, first place one hand on the keyboard, then grasp the top of the device with your other hand and gently pull away.



Customization Buttons

Look for these buttons on your touchscreen to edit and personalize your device.



Settings



Edit



Save

Guided Access

In addition to being a dedicated communication device, the **wego™ write** has *Guided Access*, which keeps the user locked into the communication software. All dedicated devices come with *Guided Access* enabled, but you may disable *Guided Access* after receiving your device. The **wego™ write** will remain dedicated to communication even with *Guided Access* disabled.

1. Open *Guided Access* by quickly triple-clicking the home button on the right side of the touch screen.
2. Enter passcode: default password is all **1s (1111 or 111111)**.

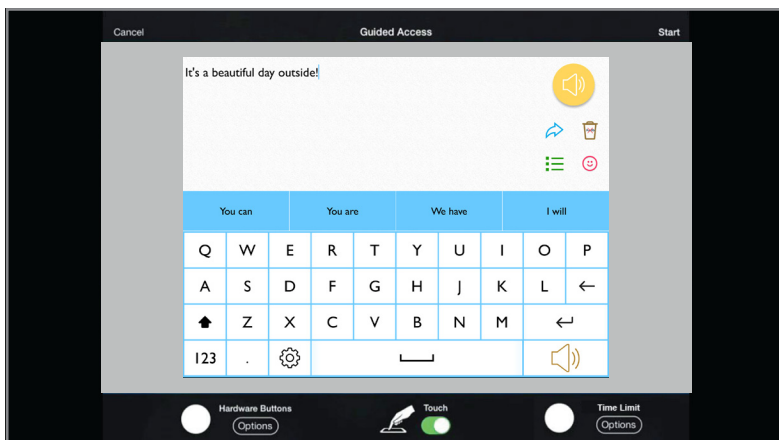

3. To continue *Guided Access*: press **Resume** (top right).
4. To turn off *Guided Access*: press **End** (top left).
5. Lock Menu (restrict use of specific buttons/categories): open *Guided Access* > use finger to draw a circle around buttons to restrict.

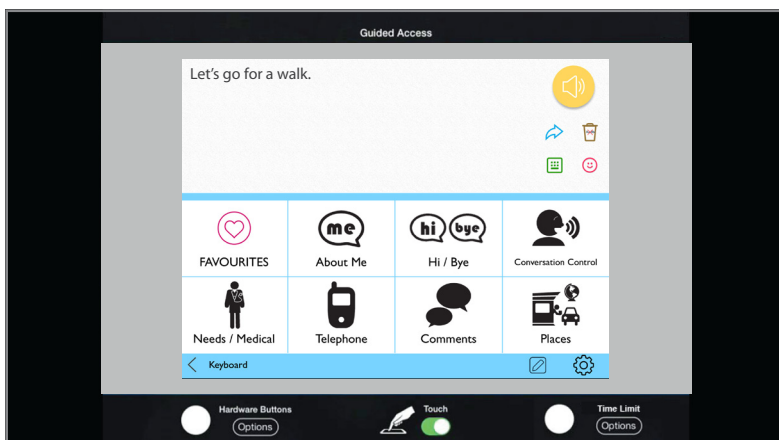

Quick Keys

Your **wego™ write** has Quick Keys located on the touchscreen and keyboard that provide quick access to various menus and commands.



Speak

Speaks out any text in the message window.



Delete

Deletes text in the message window.



Phrases

Opens your phrase categories page.



Emotes

Opens menu of emotions that sound when pressed.



Use

Opens menu with a variety of ways to use your message. The Use key is only located on the touchscreen.

Settings

Settings allow you to customize your device's speech and voice, accessibility settings, word prediction, and appearance. The settings button is located on your touchscreen.

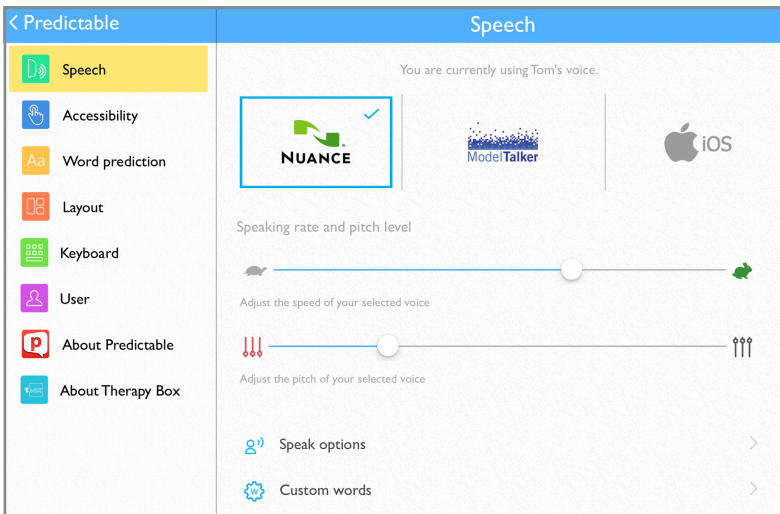

Phrase categories

The **wego™ write** allows you to save common or favorite phrases, and categorize the phrases for easy access.

Add a phrase category

1. Select **Phrases** > select the **pencil button** at bottom of page > swipe left to the last category page > tap **add category** button.

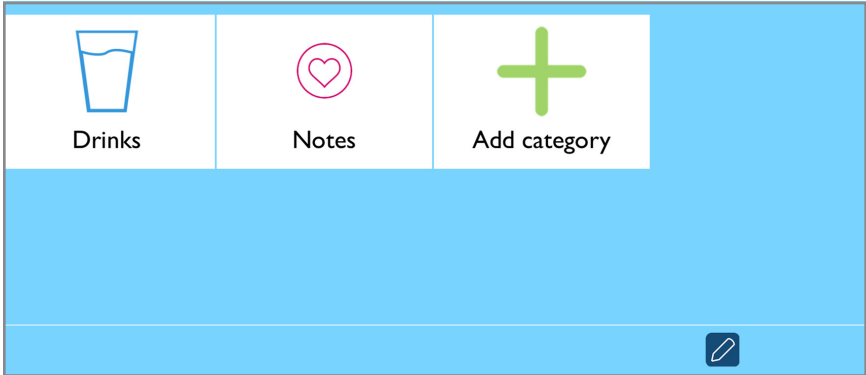

2. Type name of new phrase category at the blue cursor.
3. Select **No Image**, or select one of the following to add an image:
Take from camera > take photo using camera > Use Photo.
Choose from gallery > tap to select image from gallery.
Choose from Predictable image library > tap to select symbol.
4. When finished, tap the **save button** in the top right of screen.

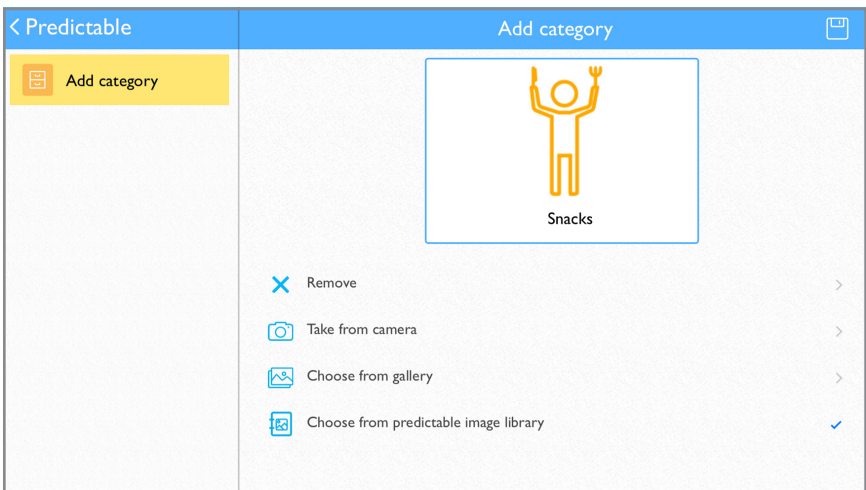

Edit a phrase category

1. Select **phrases** > select the **pencil button** at bottom of page > tap category to edit > select **Edit** to update category name or image.
2. When finished, tap the **save button** in the top right of screen.

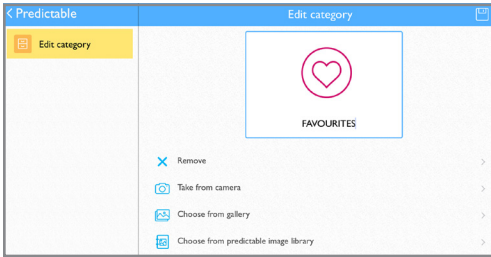

Move a phrase category

1. Select **phrases** > select the **pencil button** at bottom of page > tap category to edit > select **Move**.
2. Press and hold the category to move until it “pops” > drag category to new location.
3. When finished, tap **double arrow button** > tap **pencil button** to complete.

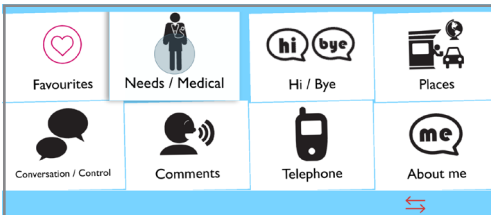

Delete a phrase category

1. Select **phrases** > select the **pencil button** at bottom of page > tap category to edit > select **Delete**.
2. A message will confirm that you want to delete category > select **yes**.
3. Select the **pencil button** at bottom of page to complete.

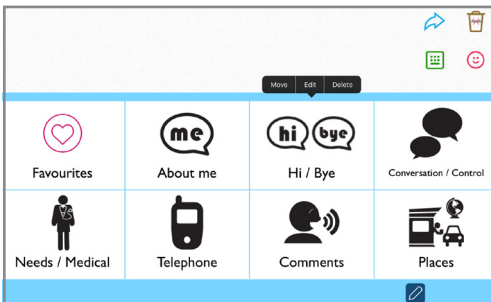

Phrases

Save a phrase

1. Select category to add new saved phrase > select **Add a new phrase** from the list of saved phrases.

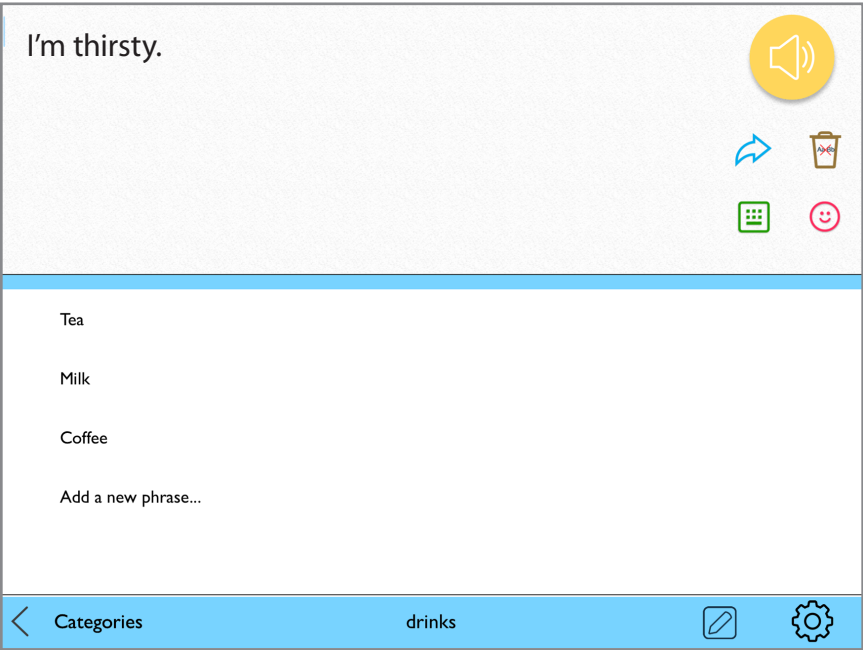

2. Select **Text** from left navigation menu.
3. On *Text to speak* line: type message to speak when phrase is selected.
4. On *Text to display* line: type text (label) to display in phrase bank.
5. When finished, tap the **save button** in the top right of screen.



Quick-save a phrase from the homepage

- 1. Type phrase using keyboard on homepage > select **Use button** on touchscreen > select **plus sign** from pop-up menu.

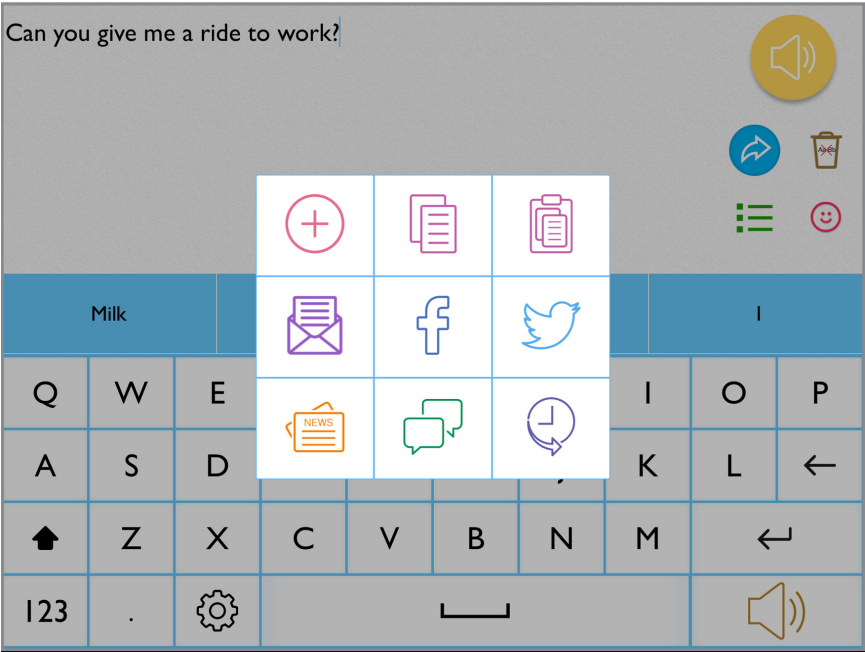

- 2. Select category to save new phrase > tap the **save button** in the top right.

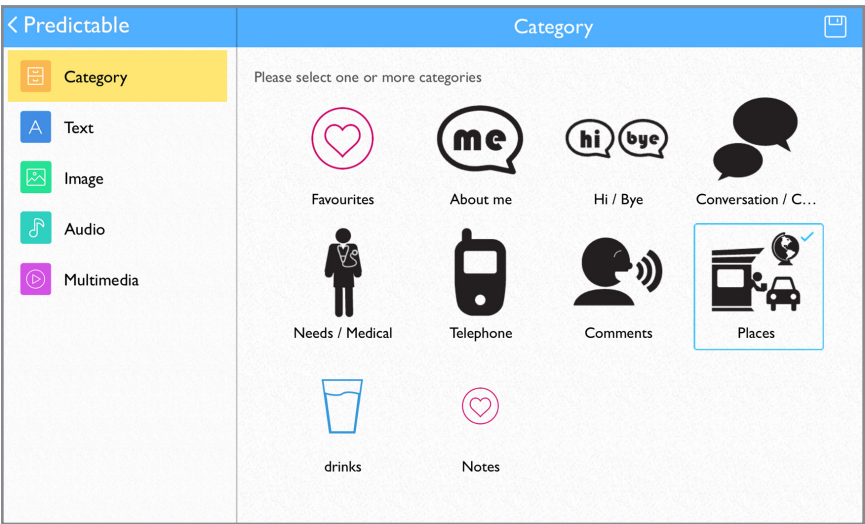

Edit a saved phrase

1. Navigate to category with phrase you wish to edit > select **pencil button** at bottom of page > tap phrase to edit > choose Edit from pop-up menu.
2. Follow steps 2-5 from Save a phrase to complete to finish editing.



Delete saved phrase

1. Navigate to phrase you wish to delete > select **pencil button** at bottom of page > choose **Delete** from pop-up menu.
2. Select **pencil button** when complete to finish editing.

Change saved phrase order

1. Navigate to category with phrase you wish to move > select **pencil button** on bottom of page > tap phrase to move > choose **Move** from pop-up menu.
2. Tap button to the right of phrase to move > drag phrase up/down to desired order within phrase bank > tap **pencil button** to finish editing.

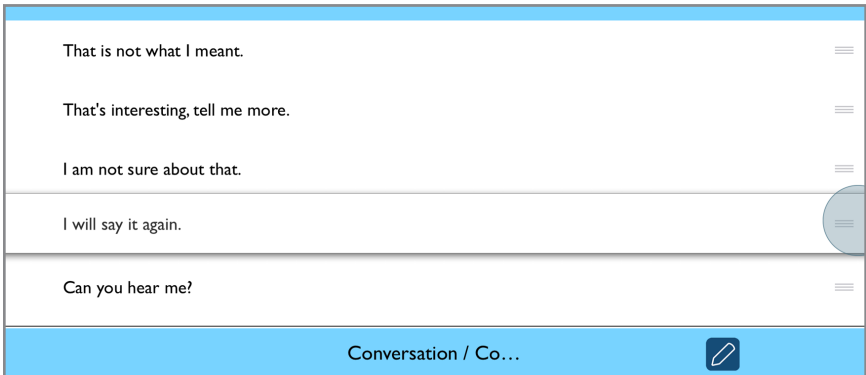

Speech

The Speech settings allow you to personalize your voice by selecting your favorite voice option, and make it your own by adjusting the speaking pitch and rate.

Change voice

1. Select settings icon on touchscreen > select **Speech** from left menu > select from *Nuance*, *ModelTalker*, or *iOS* to open voice menu > tap to select new voice.

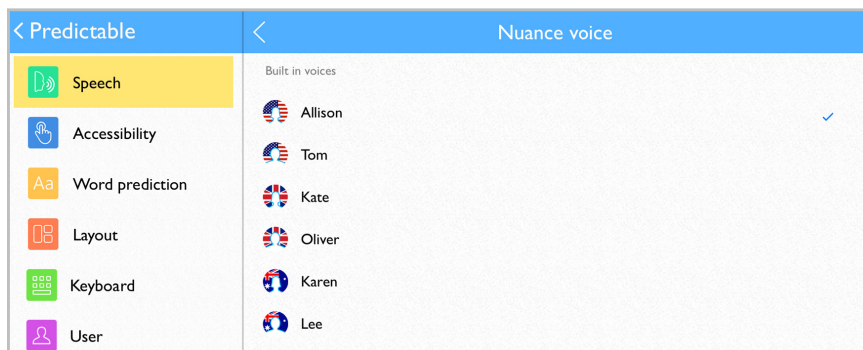

Change speaking rate, pitch, speed

1. Select **Settings** icon on touchscreen > select **Speech** from left menu.
2. To adjust speaking rate: Use finger to slide and adjust your voice rate. Slide to the left to slow and to the right to increase speed.
3. To adjust pitch: Use finger to slide and adjust your voice pitch. Slide to the left to lower and to the right to raise pitch.

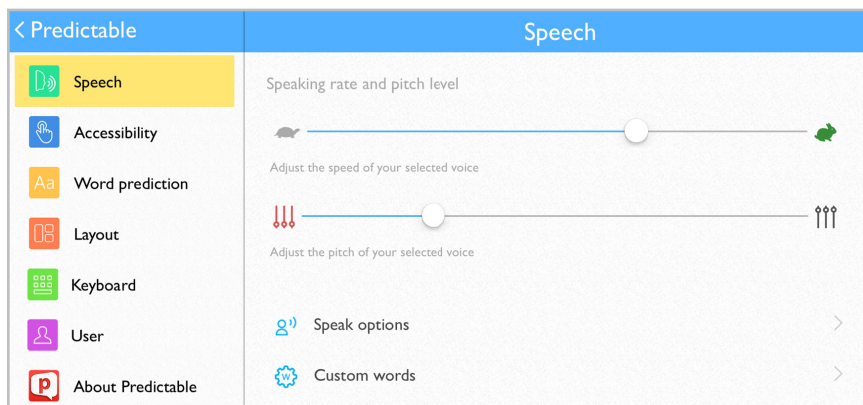

Edit speech options

Speech Options contains preferences for speech timing and message window appearance. To access: **Settings** > **Speech** > **Speak Options** > tap buttons to turn options on and off.

Pronunciation

Change pronunciation of a word

1. Select **Settings icon** on touchscreen > select **Speech** from left navigation > select **Custom Words** > select **Custom Pronunciation**.
2. On Display text line: type word with correct spelling (i.e. fajita).
3. On Pronunciation text line: type word as you want pronounced (i.e. faheeta).
4. Press the **play button** next to pronunciation to hear how word will sound.
5. When finished, tap the **save button** in the top right of screen.

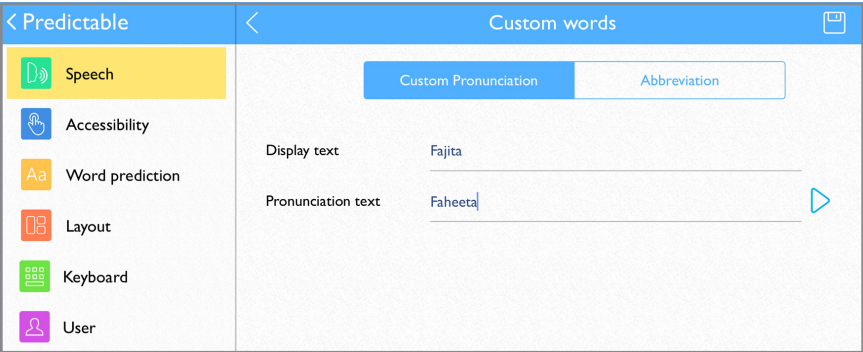

Edit pronunciation

At any point, you can edit your custom pronunciation.

1. Select **Settings icon** on touchscreen > select **Speech** from left navigation > select **Custom Words** > select **Custom Pronunciation**.
2. Tap word from pronunciation list to edit > select **edit** from menu.
3. Follow steps 2-5 above to complete editing.

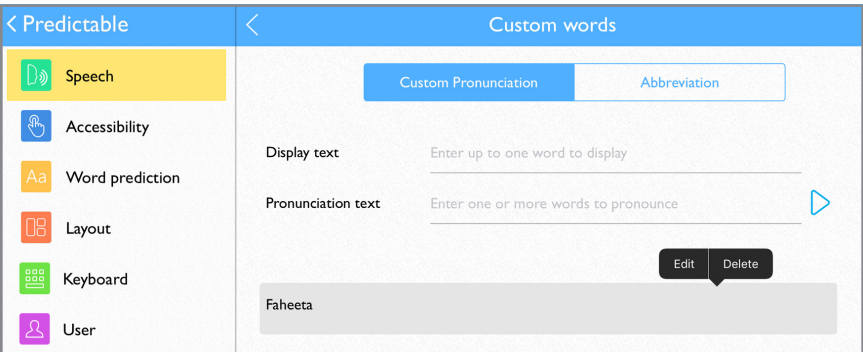

Abbreviations

To save time and keystrokes, you can create custom abbreviations. For example, if you create an abbreviation for boulevard (blvd), then Boulevard will speak when you type *blvd*.

Add abbreviation

1. Select Settings icon on touchscreen > select **Speech** from left navigation > select **Custom Words** > select **Abbreviation**.
2. On Display text line: Type word to speak and display (i.e. boulevard)
3. On Shortcut line: Type abbreviation for word (i.e. blvd).
4. When finished, tap the **save button** in the top right of screen.

Tip: Your abbreviation must have at least two letters or symbols to save.

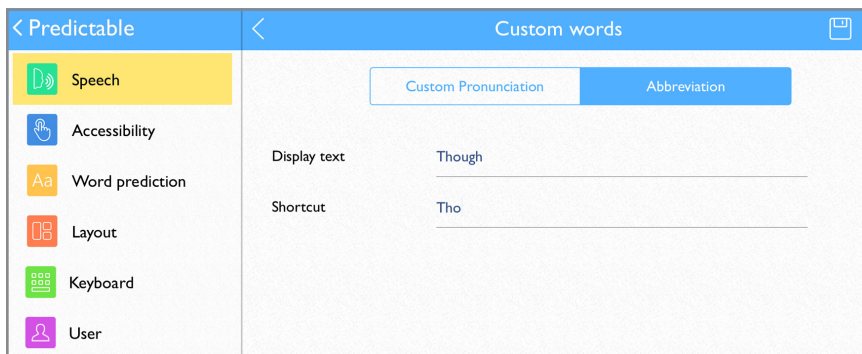

Edit abbreviation

1. Select **Settings icon** on touchscreen > select **Speech** from left navigation > select **Abbreviation** from top of page.
2. Tap word from abbreviation list to edit > select **edit** from pop-up menu.
3. Follow steps 2-3 above to complete editing.

Word prediction

Word prediction is another great time- and keystroke-saving feature built into your **wego™ write**. Your **wego™ write** analyzes as you are typing (letters and words already typed, the context from previous words/messages, and your own vocabulary) to provide real-time word predictions. The word prediction tool is self-learning and will become more accurate over time as it learns from your usage pattern along with your preferred grammar and speech style.

You may adjust the prediction text settings to meet your needs. To access: **settings > word prediction > Prediction type**.

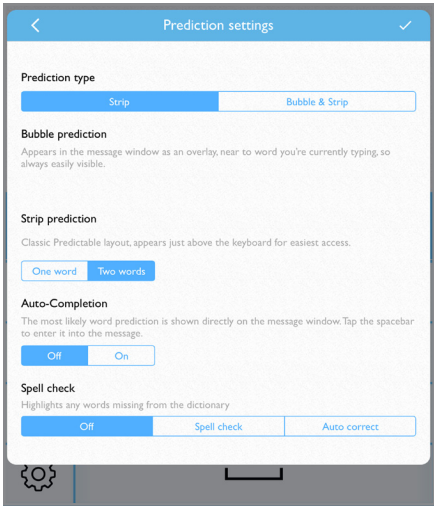

Prediction Strip

The *Word Prediction* strip appears at the top of the on-screen keyboard, displaying up to four text predictions at any time.

1. Tap word in text prediction strip to add it to message window.

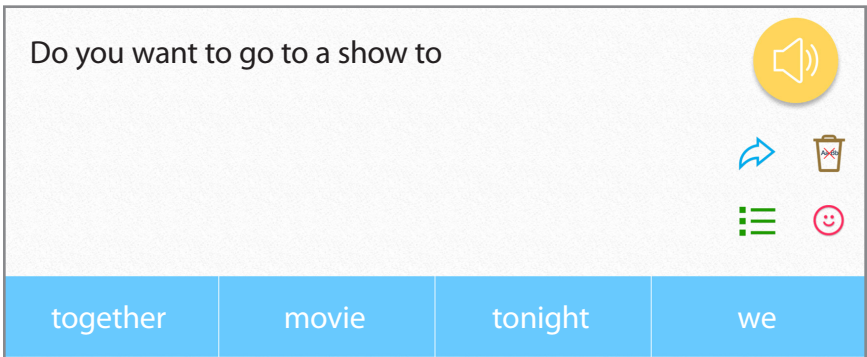

Message history

Your message saves to message history each time you push the Speak button.

1. Select the **Use button** > select the **clock icon** to open history > select phrase to add to message window.

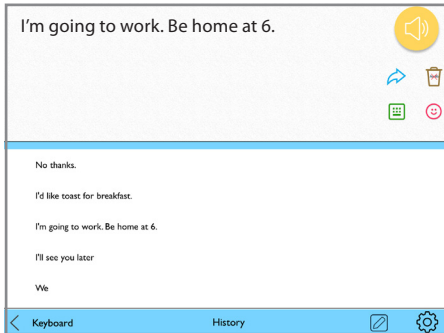

Clearing history

1. Navigate to *History* > tap the **edit button** > tap phrase to delete> select to either **delete this phrase** or **delete all**.



Emotes

Your **wego™ write** contains a menu of emotions that sound when pressed. Access the emotes menu via your Quick Keys.

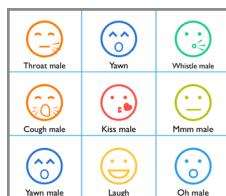

Custom Emotes

In addition to the pre-recorded emotes, you can create your own emote sounds.

1. **Settings > Layout > Manage emotes.**
2. **Create new emote** > give new emote a name.
3. Record a new emote sound or choose an existing message:

Record audio now: Press **Record audio now** > press **microphone icon** > say your emote message > press **stop icon** to finish > press **play** to test message.

Choose from Predictable message bank: Press **Choose from Predictable message bank** > press emote you want to use.

4. Tap the save icon in the top right.

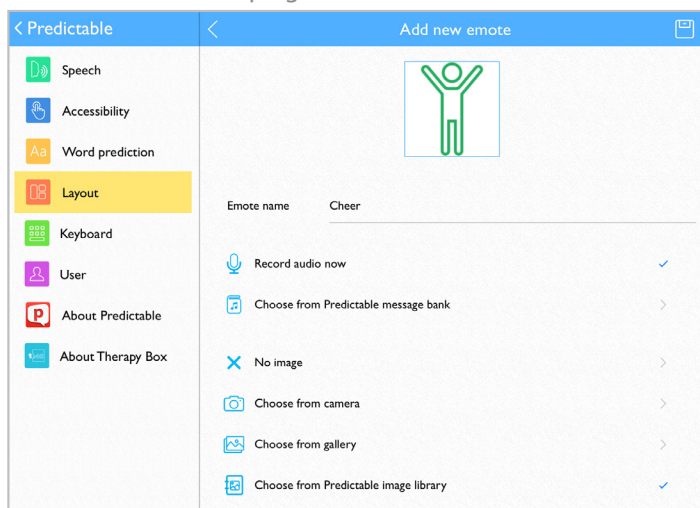

Manage Emote Menu

You can customize your Emotes menu to display the options you want to see.

1. **Settings > Manage Emotes** > tap emote options to select or deselect.

Floor hold

Floor hold allows you to speak pre-recorded sentences while typing your message and is for when you need more time to type your message before speaking it out loud. For example, use Floor hold to say “one moment please” while typing your message to speak. To use, sound a phrase by pressing the Floor hold button at the bottom of your touch screen.



Add a new floor hold phrase

1. **Settings > Accessibility > Floor hold > Add a new floor hold phrase.**

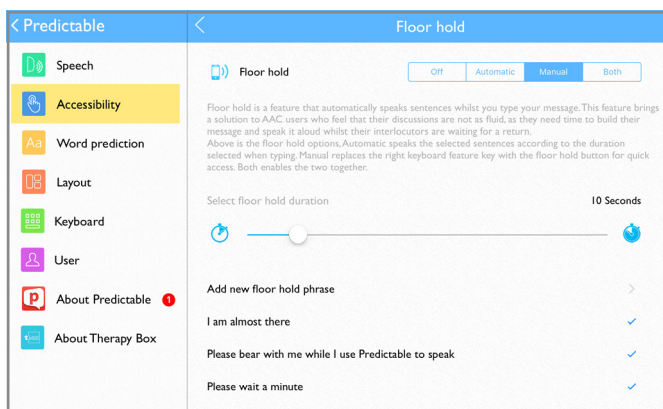

2. On *Floor hold text* line: type your new floor hold phrase.
3. Tap to select to **Use your current voice, Record the floor hold phrase, or Choose from the Predictable message bank.**
4. When finished, select the **save button** in the top right.

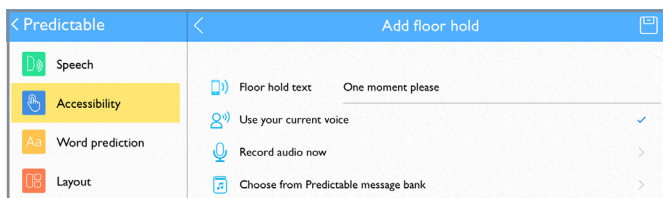

Edit floor hold phrases

1. **Settings > Accessibility > floor hold.**
2. Tap phrase to edit > select **Edit** from the pop-up menu.
3. Follow steps 2-4 above to complete editing your floor hold phrase.

Install communication software updates

Initial setup: turn on access to the App Store

1. Turn off *Guided Access*: quickly triple-click **Home** button to open *Guided Access* > enter pass code (default pass code is all **1s**) > press **End** (top right).
2. Press **Home** button to view device home screen.
3. Connect to Wi-Fi if not already: **Settings** > **Wi-Fi** > connect to your network.
4. **Settings** > **General** > **Restrictions** > enter the 4-digit pass code **9357**.
5. Tap buttons to turn on options: *Installing Apps, In-App Purchases*.
6. Press **Home** button. The App Store icon will display on device home screen.

Update software in the App Store

1. Select the **App Store** icon.
2. Select **Updates** on bottom menu bar to display applications with updates available.
3. Select **Update** button next to application.
4. If prompted, enter your Apple user ID and password (located on pg 20 of this guide). If you cannot locate your user ID or password, please contact our Support team: **877-392-2299 Option 3**, or **support@talktometechnologies.com**.

Update complete: turn off access to the App Store

1. Once update is complete: press **Home button** to return to home screen.
2. **Settings** > **General** > **Restrictions** > Enter 4-digit pass code **9357**.
3. Tap buttons to turn off the following options: *Installing Apps, In-App Purchases*.
4. Press **Home button** to return to device home screen.
5. Open vocabulary set.
6. Quickly triple-click the **Home button** to resume *Guided Access*.

User information and notes

Vocabulary account username: _____

Vocabulary account password: _____

Apple username: _____

Apple password: _____

Notes: _____













We bring speech to life™

Need Help?



877.392.2299 Option 3



support@talktometechnologies.com



talktometechnologies.com/support



Join in the conversation...

Connect with us for resources, contests and more!